

## INSTALLATION INSTRUCTIONS

DESCRIPTION: Rear Carrier Kit  
PART # 1RC-F48D0-V0  
MODEL: FZ-09



### DEALER OR INSTALLER:

Please keep a copy of these as they contain important information for future reference.

#### **⚠ WARNING**

Please read and understand these instructions completely before installation to avoid possible injury to yourself, or damage to the accessory or vehicle.

#### **NOTICE:**

This installation requires a Yamaha Service Manual, torque wrench, and a 27 mm hole saw drill bit.

#### **WARRANTY INFORMATION:**

Genuine Yamaha accessories are covered by a one-year warranty against defects in material or workmanship. Labor for replacement of defective components is not covered. See your Yamaha dealer for a copy of the warranty statement. The Limited Warranty provided with new Yamaha vehicles has exclusions for certain failures, including those caused by competition or racing use as well as by abnormal strain or abuse. While installation of these components will not "void" your vehicle's warranty, specific failures adjudged by Yamaha to have resulted from the installation of accessory components or other modifications or from competition use may not be covered by warranty or Yamaha Extended Service.

### PARTS LIST:

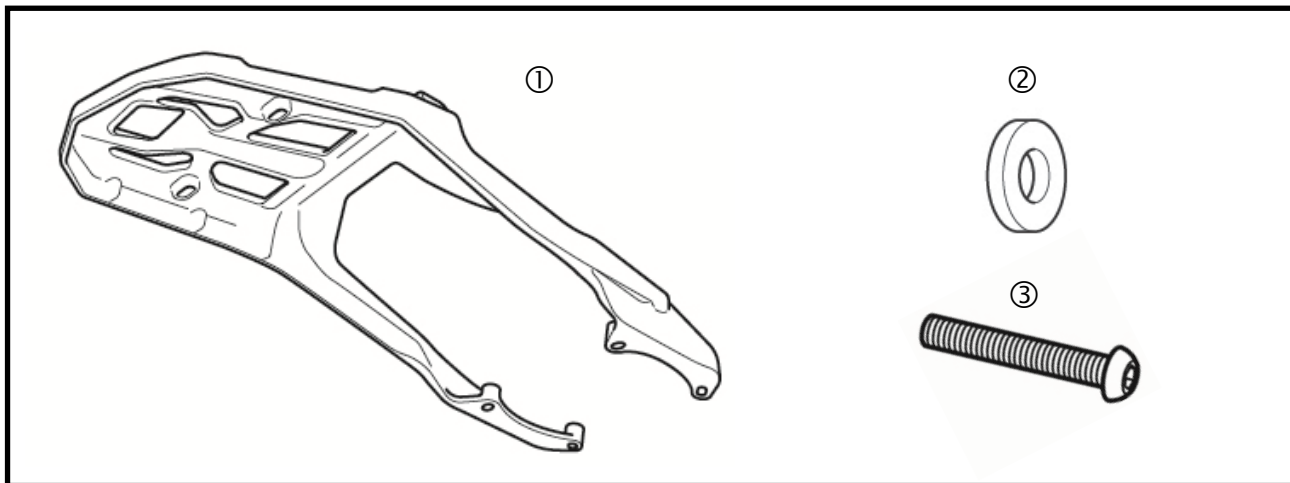

No.	Part Number	Description	Qty
--	1RC-F48D0-V0	Rear Carrier Kit	--
①	*	Rear Rack	1
②	*	Washer M8	4
③	*	Button Head Bolt M8 x 40 mm	4

\* Part supplied with kit only and not available separately.

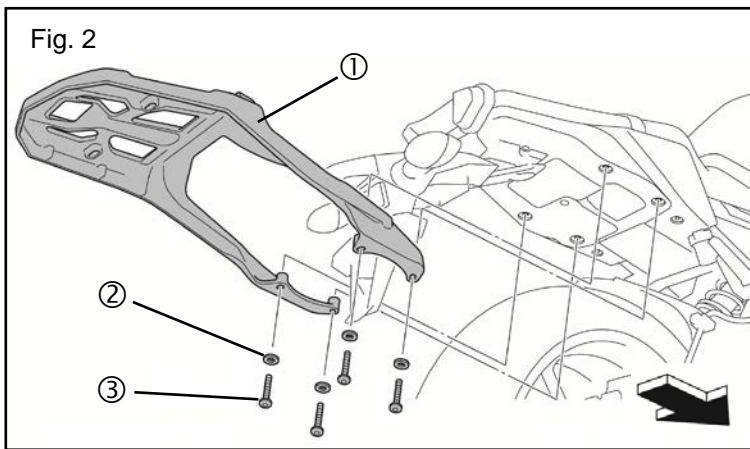
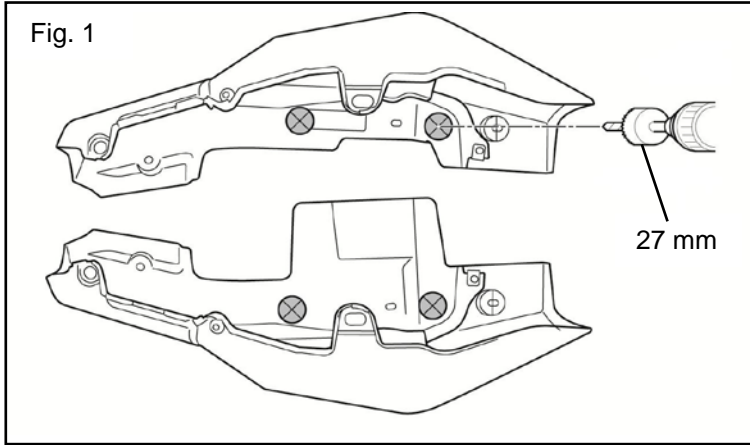

**PREPARATION:**

1. Stand motorcycle on a secure and level surface.
2. Clean all mounting surfaces before beginning installation.

**INSTALLATION:**

1. Remove seat.
2. Remove rear cowls referencing the Yamaha Service manual.
3. Drill out the pre-marked X's on each inner cowl using a 27 mm hole saw drill bit as shown in Fig. 1.

**TIP:**

**Properly aligning the bit in the center of the X will provide a better fit.**

4. Install rear cowls referencing the Yamaha Service Manual.
5. Torque the four cowl bolts to 7 Nm (0.7 m • kgf, 5.1 ft • lbf).
6. Install rear rack ① using four washers ②, and four button head bolts ③ as shown in Fig. 2.
7. Torque button head bolts to 23 Nm (2.3 m • kgf, 17 ft • lbf).

**⚠ WARNING**

**Do not exceed the maximum load of 5 kg (11 lb).**

**MAINTENANCE:**

Periodically check all hardware for tightness and re-torque as necessary.

**CARE AND CLEANING:**

Wash using a mild soap and water solution and soft cloth. Protect with Yamaha Spray Polish (p/n # ACC-SPRAY-PL-SH).

**CUSTOMER SERVICE:**

For further information see your Yamaha dealer.

**ESTIMATED TIME TO INSTALL: 0.3 HRS**